

## D140W

### Swing Check Valves



PN25

D140W

PUBLIC HEALTH

#### Features & Benefits

- Check Valves permit flow in one direction only and close automatically if flow reverses
- They are entirely automatic in action, depending upon pressure and velocity of flow within the line to perform their functions of opening and closing

#### Materials

| PART               | MATERIAL                     | SPECIFICATION      | SIZES     |
|--------------------|------------------------------|--------------------|-----------|
| Body               | Bronze                       | BS EN 1982 CC491K  | All       |
| Cap                | Bronze                       | BS EN 1982 CC491K  | All       |
| Disc Holder        | Brass                        | BS EN 12164 CW614N | 3/4 - 1   |
| Disc Holder        | Bronze                       | BS EN 1982 CC491K  | 1 1/4 - 2 |
| Disc               | WRAS Approved Nitrile Rubber |                    | All       |
| Disc Retaining Nut | Brass                        | BS EN 12164 CW614N | All       |
| Washer             | Brass                        | BS EN 12164 CW614N | All       |
| Hinge              | Bronze                       | BS EN 1982 CC491K  | All       |
| Hinge Pin          | Stainless Steel              |                    | All       |
| Hinge Nut          | Brass                        | BS EN 12164 CW614N | All       |

#### Dimensions & Weights

| SIZE (inch) | A (mm) | B (mm) | WEIGHT (kg) |
|-------------|--------|--------|-------------|
| 3/4         | 66     | 42     | 0.43        |
| 1           | 80     | 49     | 0.63        |
| 1 1/4       | 89     | 56     | 1.01        |
| 1 1/2       | 95     | 65     | 1.34        |
| 2           | 108    | 76     | 2.12        |



#### Dimensional Drawing

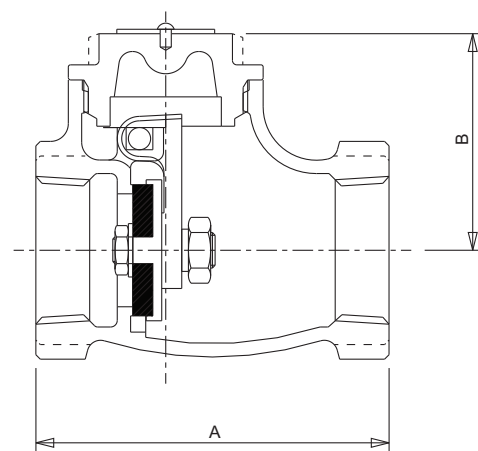

#### Pressure/Temperature Ratings

|                  |           |
|------------------|-----------|
| TEMPERATURE (°C) | -10 to 85 |
| PRESSURE (BAR)   | 25        |

**MIN OPENING PRESSURE:** PN25

**TEMPERATURE OPERATING RANGE:** -10 to 85°C

**UK END CONNECTIONS:** Taper threaded to BS EN 10226-2 (ISO 7-1) OPERATOR: Swing type Check Valve

**SPECIFICATION: D140W:** Valves are manufactured in accordance with BS 5154: 1991 PN25 for Series B ratings but are limited to 85°C maximum temperature. This valve is not suitable for use on Group 2 gases, Group 1 gases or unstable fluids, as defined by the Pressure Equipment Directive 97/23/EC.\*

\* See page 251 for more information