

# FLANGED RUBBER FLEXIBLE JOINT PN10-PN16 FIG. FRJ 513

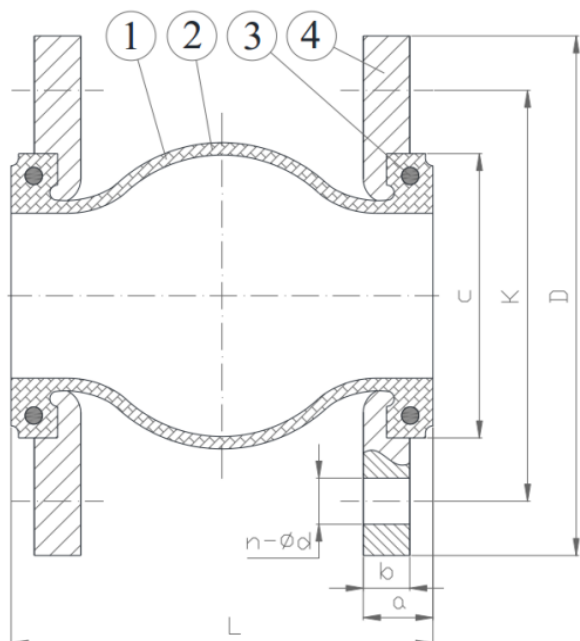

### MAIN FEATURES

Angle of Deflection	15°
Applicable Temp	-15~115°C

### DIMENSIONS

DN	L	K		D		n-ød	
		PN10	PN16	PN10	PN16	PN10	PN16
50	105	125	125	165	165	4-18	4-18
65	115	145	145	185	185	4-18	4-18
80	135	160	160	200	200	8-18	8-18
100	150	180	180	220	220	8-18	8-18
125	165	210	210	250	250	8-18	8-18
150	180	240	240	285	285	8-23	8-23
200	210	295	295	340	340	8-23	12-23
250	230	350	355	395	405	12-23	12-27
300	245	400	410	445	460	12-23	12-27
350	255	460	470	505	520	16-23	16-27
400	255	515	525	565	580	16-27	16-30
450	255	565	585	615	640	20-27	20-30
500	255	620	650	670	715	20-27	20-33

### MATERIALS OF MAIN PARTS

	PARTS	MATERIALS
1	Body	EPDM
2	REINFORCE	NYLON
3	WIRE	STEEL
4	FLANGE	ZINC PLATED