

Resilient Seat Gate Valve F4 (BS5163) FIG. DGV 020

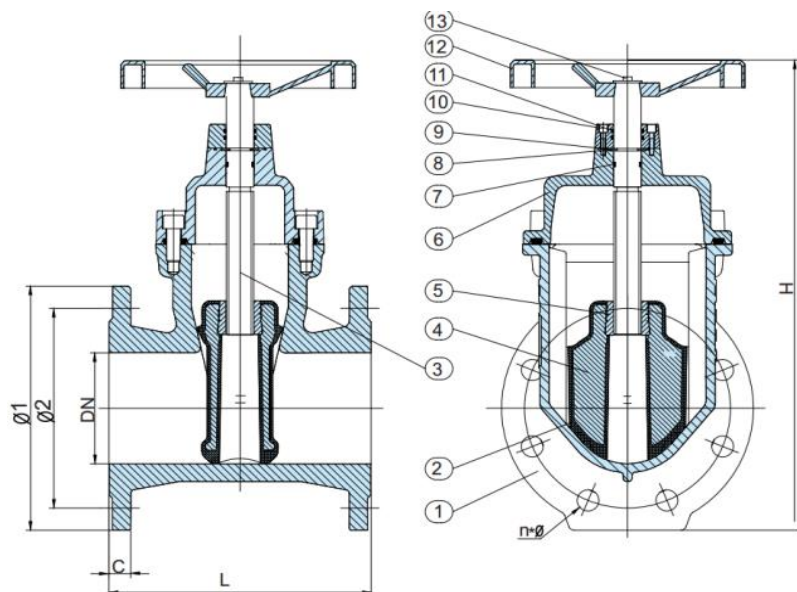

DESIGN STANDARD	BS5163
FACE TO FACE	BS5163
FLANGES	BS4504
TESTING	BS6755

TECHNICAL DATA

WORKING PRESSURE	16bar	
TESTING PRESSURE	SHELL TEST	24bar
	SEALING TEST	17.6bar

MATERIALS OF MAIN PARTS

	PARTS	MATERIALS
1	Body	Ductile Iron
2	Seat	EPDM
3	Shaft	ANSI 420
4	Disc	Ductile Iron
5	Wedge Nut	Brass
6	Bonnet	Ductile Iron
7	O ring	EPDM
8	Thrust Washer	Brass
9	Sealing ring	EPDM
10	socket head screw	Carbon Steel
11	Oring	EPDM
12	Hand Wheel	Ductile Iron
13	Stem Nut	Brass

DN	L	H	Ø1		Ø2		n-Ø	
			PN10	PN16	PN10	PN16	PN10	PN16
40	165	285	150	150	110	110	4-18	4-18
50	178	300	165	165	125	125	4-18	4-18
65	190	345	185	185	145	145	4-18	4-18
80	203	390	200	200	160	160	8-18	8-18
100	229	430	220	220	180	180	8-18	8-18
125	254	510	250	250	210	210	8-18	8-18
150	267	565	285	285	240	240	8-22	8-22
200	292	680	340	340	295	295	8-22	12-22
250	330	820	395	405	350	355	12-23	12-26
300	356	930	445	460	400	410	12-23	12-26
350	381	1020	505	520	460	470	16-23	16-26
400	406	1100	565	580	515	525	16-26	16-30
500	457	1250	670	715	620	650	20-26	20-33