

D181C

Service Ball Valve



PN16

D181C



GENERAL VALVES

Features & Benefits

- Light, compact and easy to install and operate
- WRAS approved for use on wholesome (potable) water
- Compression ends to BS EN 1254-2 for use with BS EN 1057 R250
- Chrome plated finish
- Handle can be removed to allow for screwdriver operation

Materials

PART	MATERIAL	SPECIFICATION	QUANTITY
Screw	Steel	Dacromet Plated	1
Handle	Nylon (Ral 9017)		1
Stem	DZR Brass	Chromium Plated	1
O-Ring	EPDM	WRAS approved	1
Nut	DZR Brass	CW602N Chromium Plated	2
Olive	Brass	CW507L	
Body	DZR Brass	CW602N Chromium Plated	
PTFE Seat	PTFE	WRAS approved	
Ball	DZR Brass	CW602N Chromium Plated	
Seat Retainer	DZR Brass	CW602N Chromium Plated	1

Dimensional Drawing

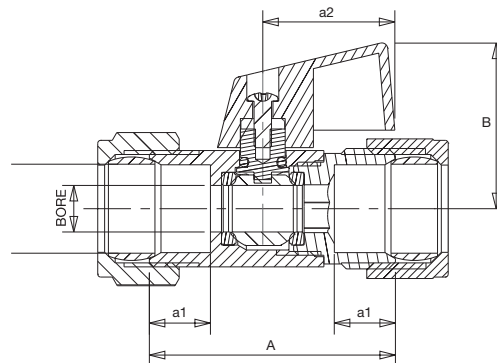

Dimensions & Weights

SIZE (mm)	BORE (mm)	A (mm)	a1 (mm)	a2 (mm)	B (mm)	WEIGHT (kg)
DN15	ø8	42	10.5	23	28.3	0.124
DN22	ø13.5	53	12.5	23	33.1	0.268

Pressure/Temperature Ratings

TEMPERATURE (°C)	-10 to 30	65	110	120
PRESSURE (BAR)	16	10	6	5

Intermediate pressure ratings shall be determined by interpolation.

PRESSURE RATING: PN16

OPERATOR: Handle.

The handle can be removed to allow for screwdriver operation.

SPECIFICATION: Compression ends to BS EN 1254-2 for use with BS EN 1057 R250 (half-hard) copper tube. WRAS approved product.